

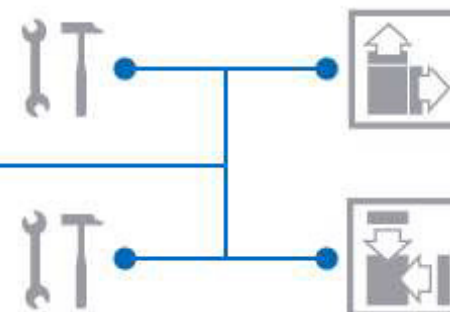

AFMT 12 Q (7 129 15 ...)
 AFMT 12 QSL (7 129 25 ...)





Technical data

Technical data

All the technical data can be found in the operating instructions for the model.

Tests

Up-to-date test data and test instructions after repair can be found on the FEIN Extranet (Customer Service → Repair Guides).

Lubricants / Auxiliary substances

The lubricants or auxiliary substances and their container sizes available from FEIN can be found on the FEIN Extranet (Customer Service → Repair Guides).

Lists of spare parts

Lists of spare parts and exploded views are available online at www.fein.com



Please note

These instructions are only intended for persons with suitable technical training. It is assumed that the reader has mechanical and electrical training.

Only use original FEIN spare parts.

Provisions

Please note that power tools may only be repaired, maintained and checked by a trained electrician, as improper repair can result in serious risks to the user.

The provisions set out in **DIN VDE 0701-0702** should be observed after repairs.

The relevant accident prevention regulations of the employer's liability insurance associations are to be observed when commissioning.

The German Equipment and Product Safety Act [ProdSG] applies for correct use.

Outside Germany, the regulations applicable in the relevant country must be observed.

**Lubricants and auxiliary substances required****Lubricants**

Grease	0 40 101 0100 4	7 g	Gearbox housing
--------	-----------------	-----	-----------------

Auxiliary substances

Thread-locking fluid e.g. Loctite 638	09000600906	high strength	Gearbox housing
--	-------------	---------------	-----------------



Not yet available.



Removal

Removing the battery



1. Press and hold the catch (1).
2. Pull off the battery.



Removal

Removing the motor housing

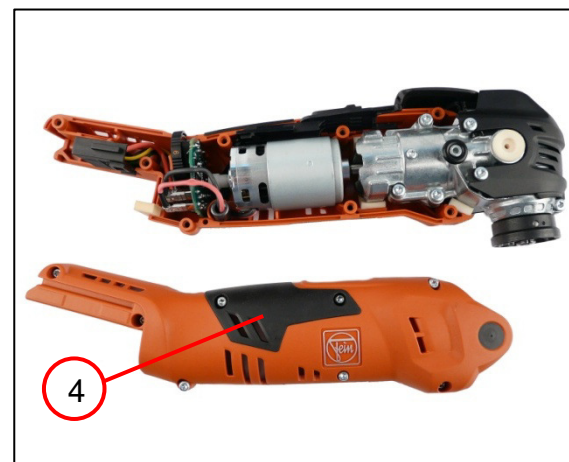
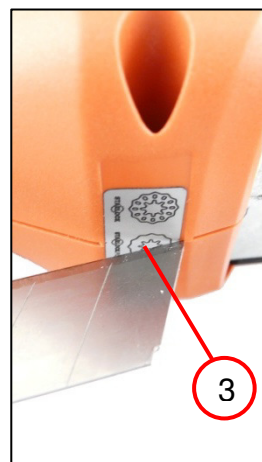
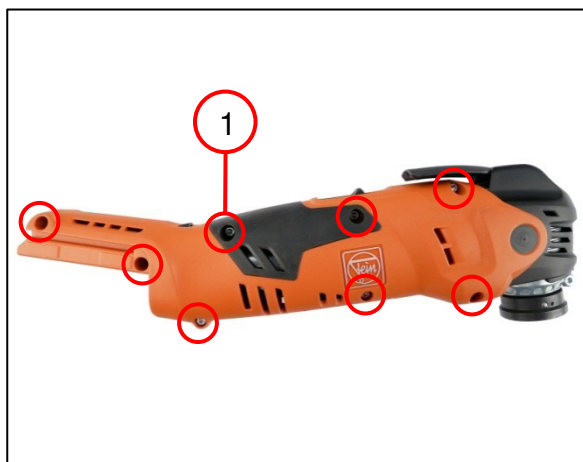

1. Unscrew the eight screws (1).
2. Cut through the type plate (2).
3. Cut through the sticker (3).
4. Remove the motor housing (4).

Tools:

- Torx T15
- Blade

Removal

Removing the motor housing

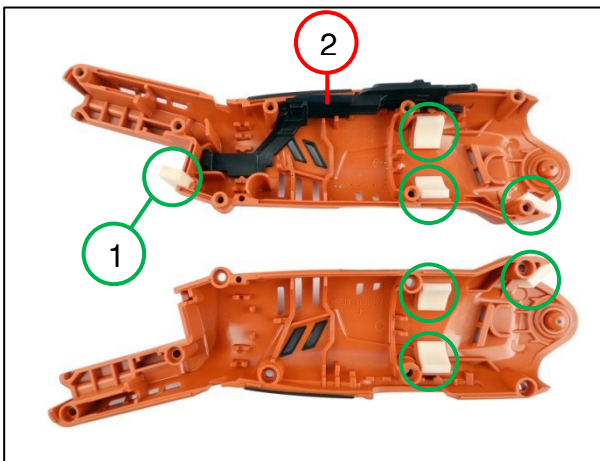
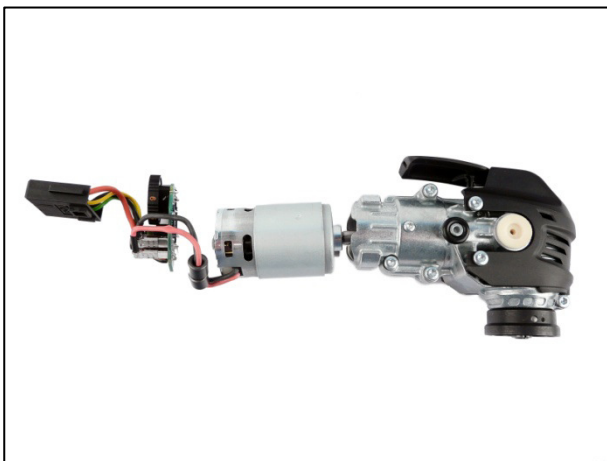

1. Remove the electronics, the motor and the tool head from the motor housing.
2. Remove the seven pressure pieces (1).
3. Remove the slide switch (2).

Removal

Removing the motor

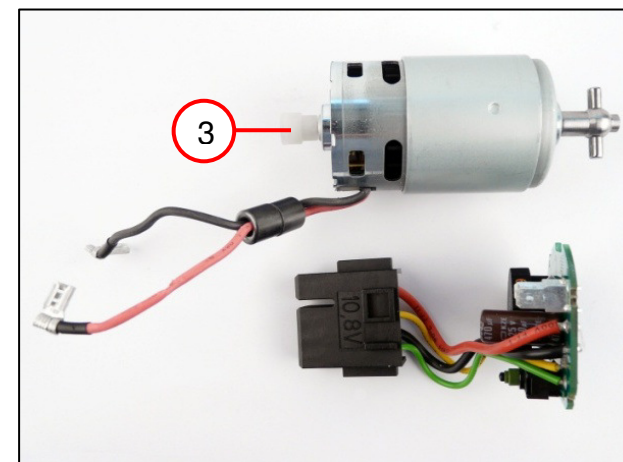
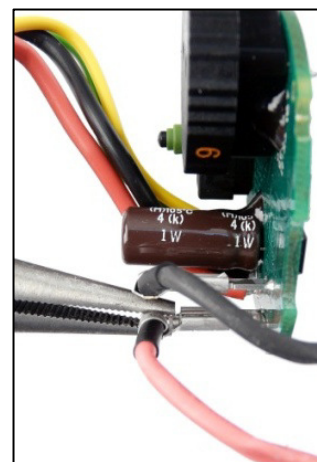
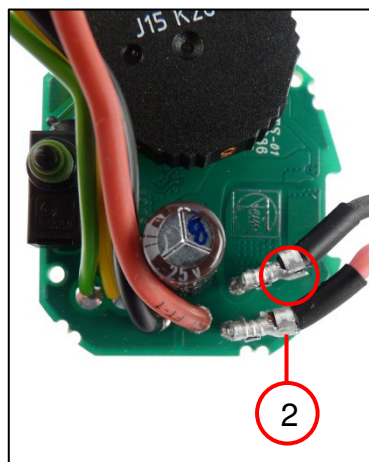
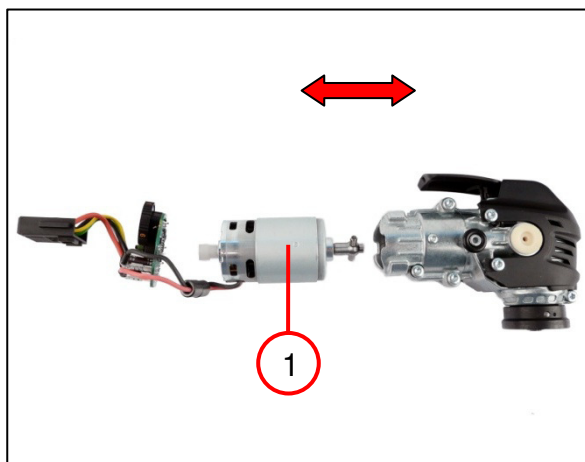

1. Remove the motor (1).
2. Remove the two cables (2).
3. Remove the magnet (3).

Tools:

- Long-nosed pliers



Removal

Removing the gearbox housing

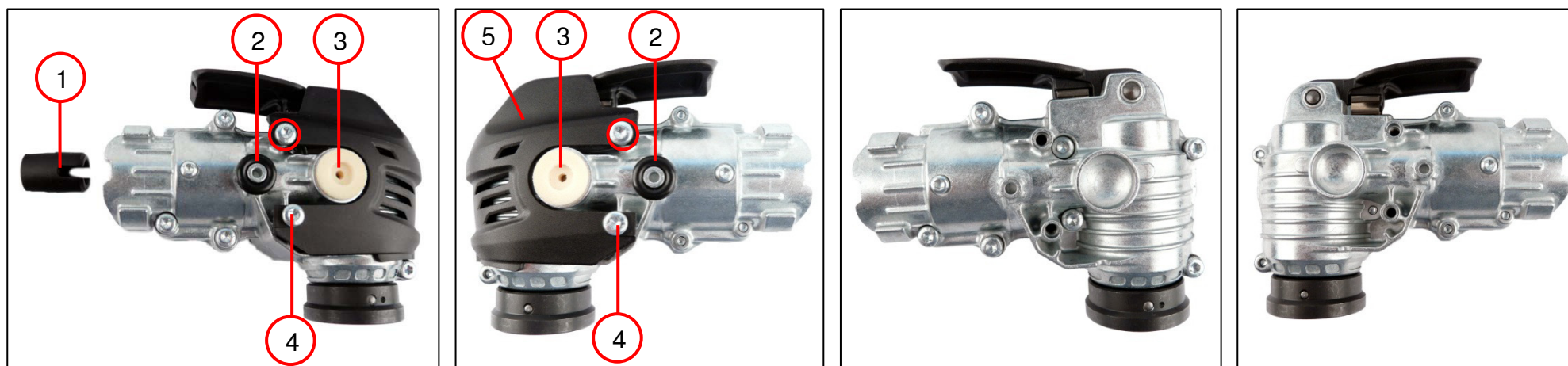

1. Remove the clutch part (1) from the gearbox housing.
2. Remove the two rings (2).
3. Remove the two pressure pieces (3).
4. Remove the four screws (4) of the protective cap.
5. Remove the protective cap (5).

Tools:

- Torx T15

Removal

Removing the gearbox housing

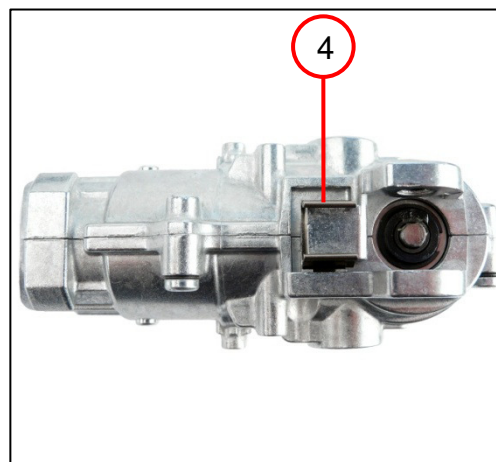
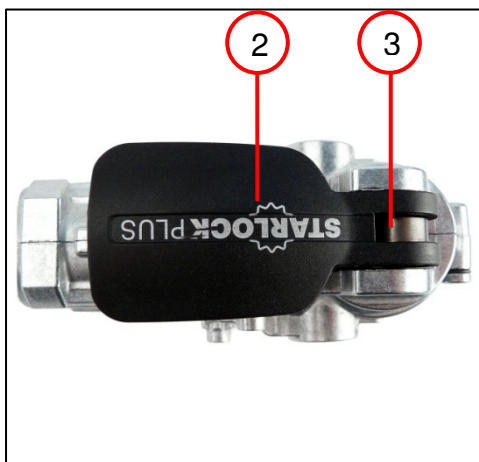
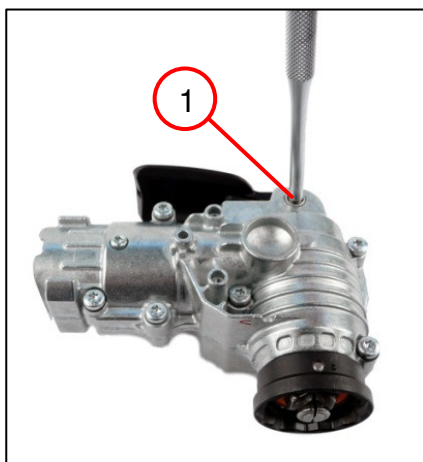

1. Remove the straight pin (1).
2. Remove the lever (2).
3. Remove the eccentric ring (3).
4. Remove the locking spring (4).

Tools:

- Hammer
- Punch with 5 mm diameter



Removal

Removing the gearbox housing

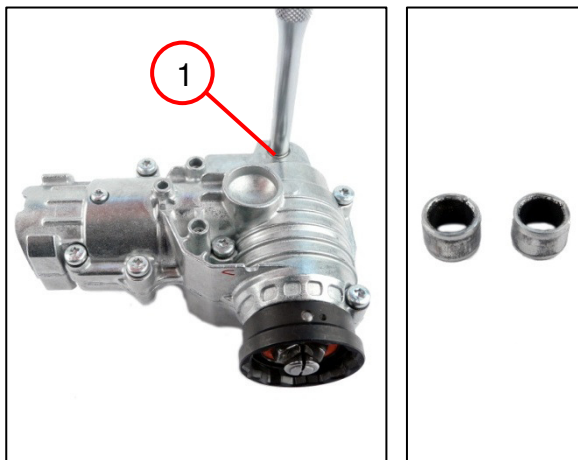

1. Remove the two bushes (1).

Tools:

- Hammer
- Punch with 7 mm diameter

Removal

Removing the gearbox housing

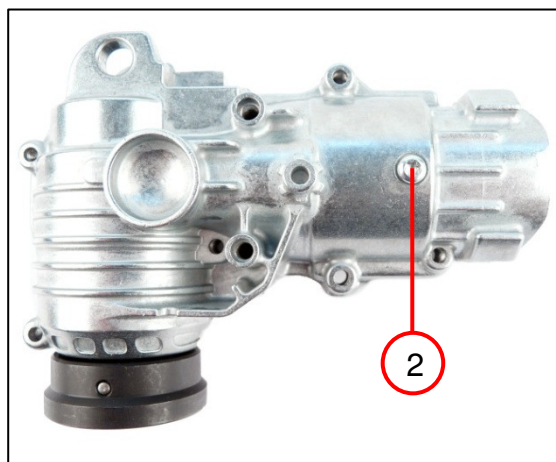
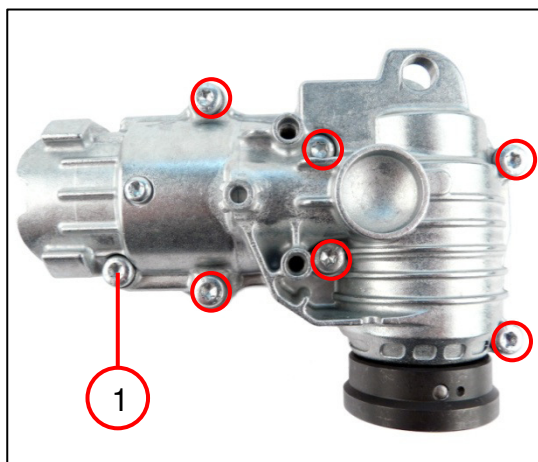

1. Unscrew the seven screws with circlip (1).
2. Unscrew the screw (2).
3. Open the gearbox housing (3).

Tools:

- Torx T15
- Plastic hammer
- Blade



Removal

Removing the gearbox housing

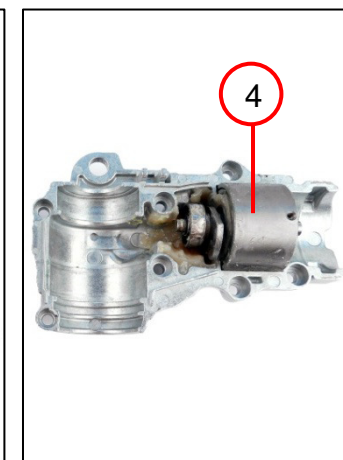
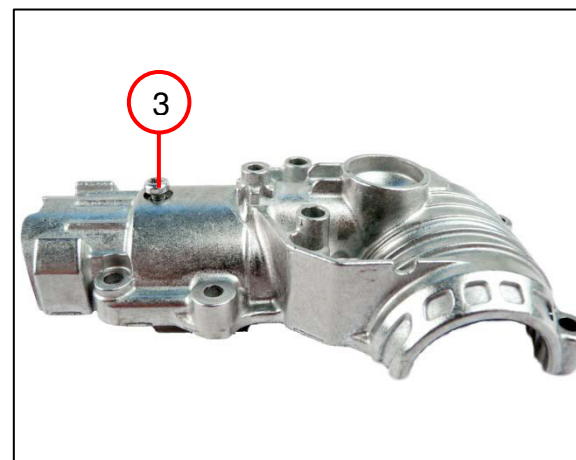
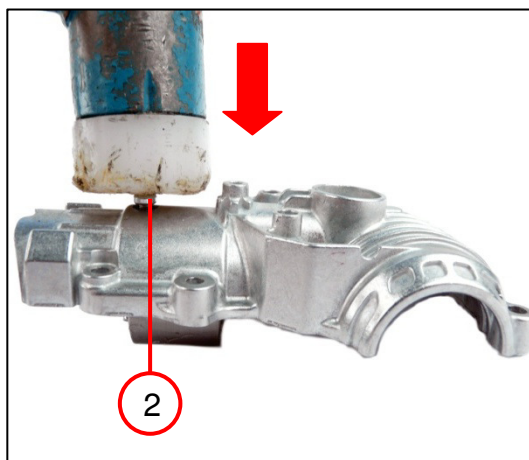
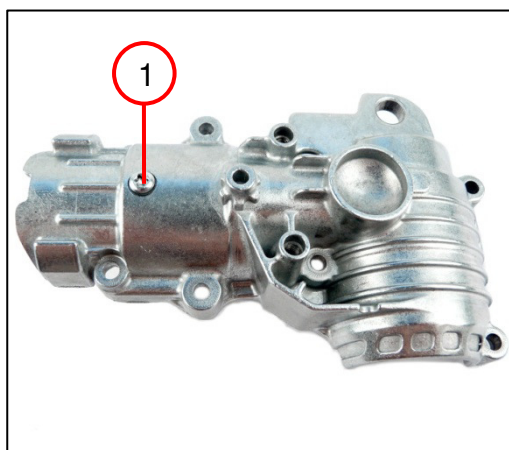

1. Open the screw slightly (1).
2. Use the screw (2) to tap the eccentric shaft out of the gearbox housing.
3. Unscrew the screw (3).
4. Remove the eccentric shaft (4).

Tools:

- Torx T10
- Plastic hammer

Removal

Removing the gearbox housing

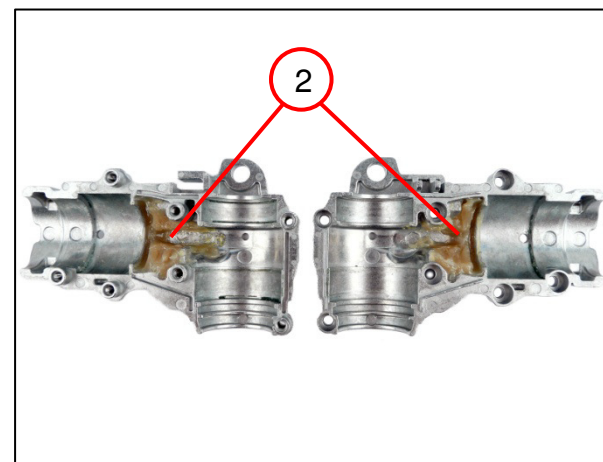
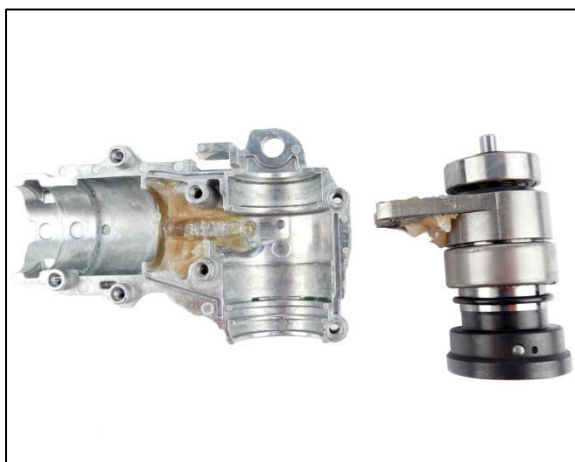
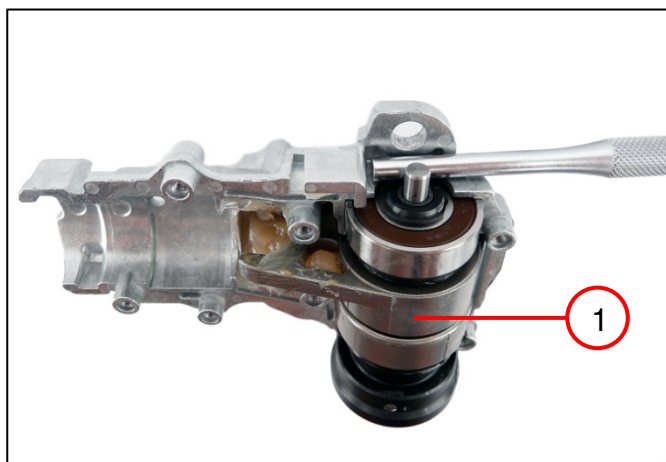

1. Remove the clamping unit (1).
2. Completely remove the grease from the gearbox housing (2).

Tools:

- Punch with 5 mm diameter



Removal

Removing the clamping unit (AFMT 12 Q)



1. Remove the sealing ring (1).
2. Remove the needle sleeve (2).



Removal

Removing the clamping unit

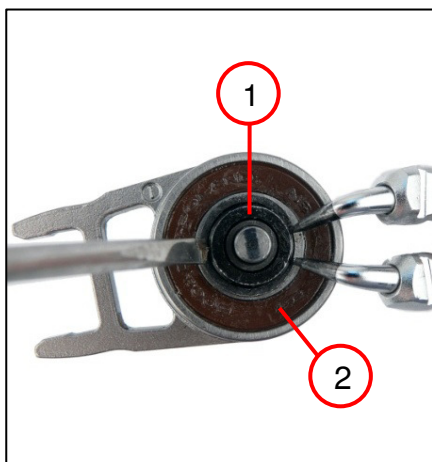

1. Remove the circlip (1).
2. Pull off the grooved ball bearing (2).

Tools:

- Circlip pliers
- Slotted screwdriver
- Drawing-off socket cap
- Chuck cone 28 mm

Fitting

Fitting the clamping unit

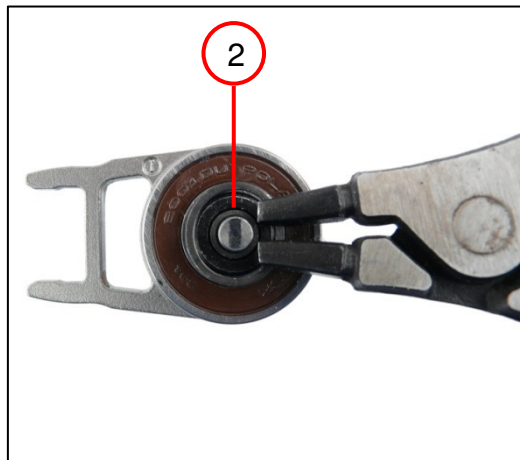

1. Press on the grooved ball bearing (1).
2. Fit the circlip (2).

Tools:

- Arbor press
- Sleeve
13 mm inner diameter
30 mm outer diameter
- Circlip pliers



Fitting

Fitting the clamping unit (AFMT 12 Q)

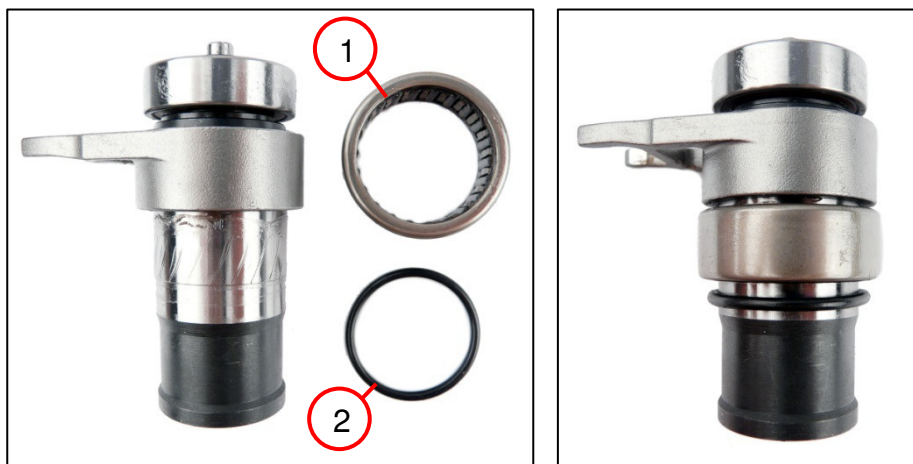

1. Slide on the needle sleeve (1).
 - ☞ Coat the needle sleeve with grease.
2. Slide on the sealing ring (2).
 - ☞ Coat with oil.

Fitting

Fitting the gearbox housing

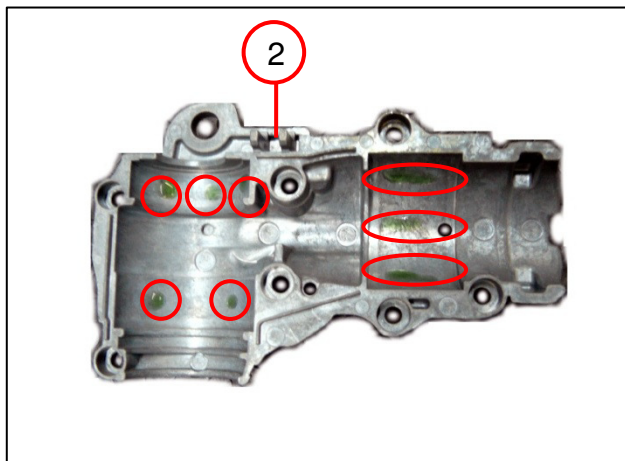
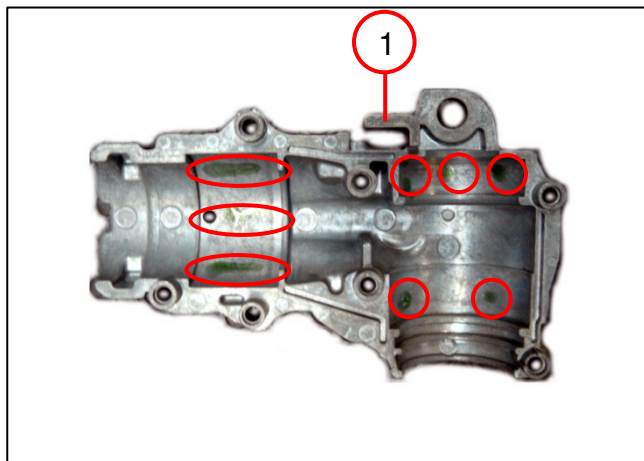

1. Coat the gearbox housing (1) with thread-locking fluid.
 - ☞ Clean the adhesive surfaces.
1. Coat the gearbox housing (2) with thread-locking fluid.
 - ☞ Clean the adhesive surfaces.

Fitting

Fitting the gearbox housing

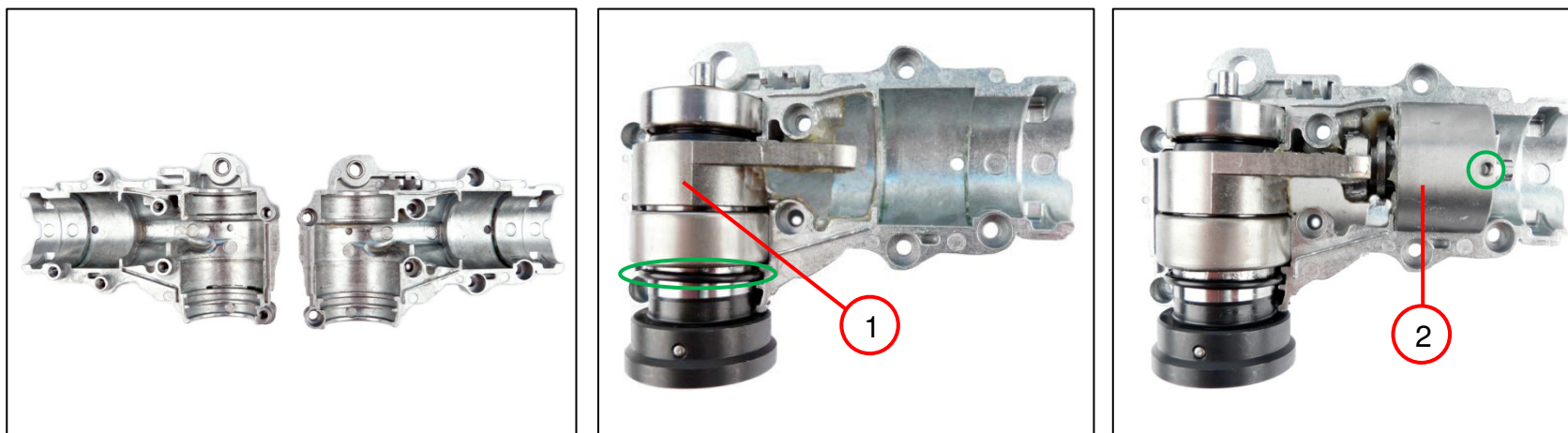

1. Insert the clamping unit (1) in the correct position.
 - ☞ Insert the sealing ring in the correct position.
2. Insert the eccentric shaft (2) in the correct position.



Fitting

Fitting the gearbox housing

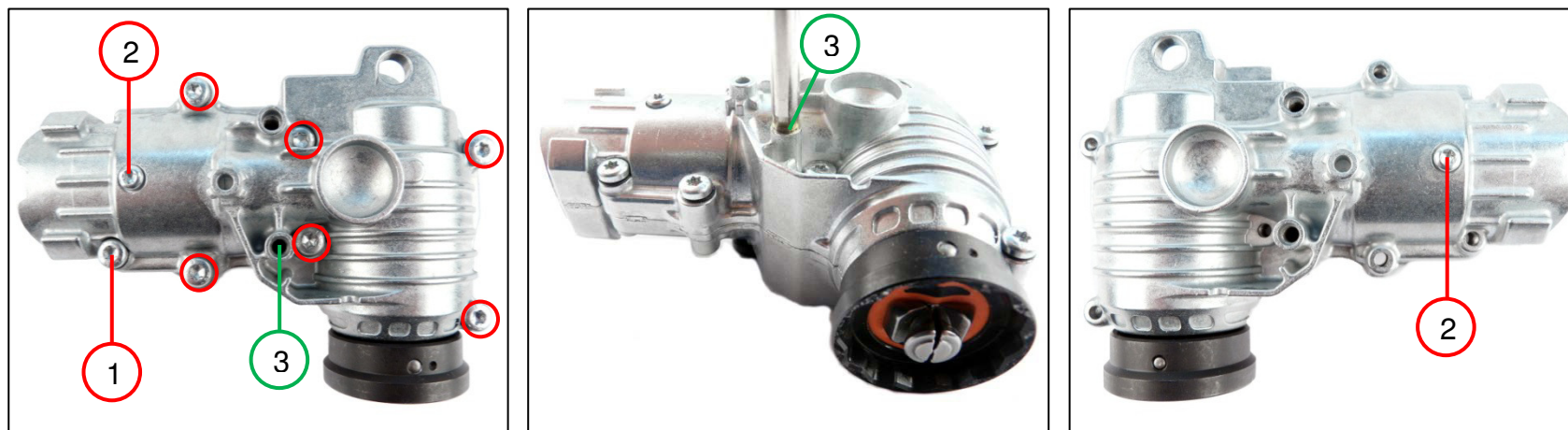

1. Fit the gearbox housing.
2. Screw in the seven screws with circlip (1) [$2.6^{+0.2}$ Nm].
 ☞ Retighten the screws after 24 hours [$2.6^{+0.2}$ Nm].
3. Screw in the two screws (2) [$1.3^{+0.2}$ Nm].
 ☞ Retighten the screws after 24 hours [$1.3^{+0.2}$ Nm].
4. Fill the gearbox housing (3) with 7 g of grease.

Tools:

- Torque wrench
T15
- Torque wrench
T10
- Syringe



Fitting

Fitting the gearbox housing

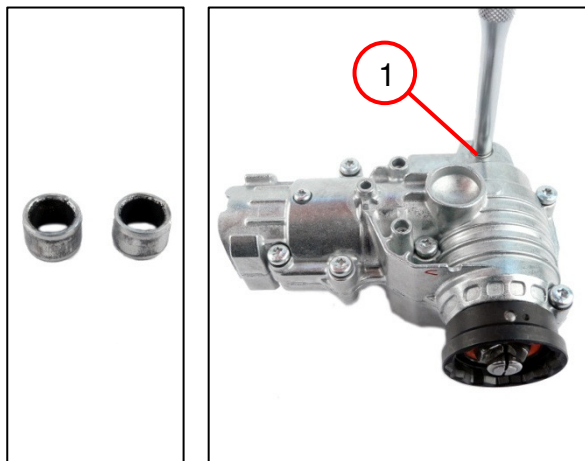

1. Press in the two bushes (1).

Tools:

- Hammer
- Punch with 7 mm diameter

Fitting

Fitting the gearbox housing

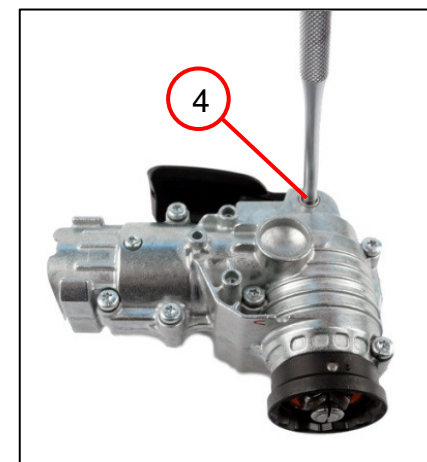
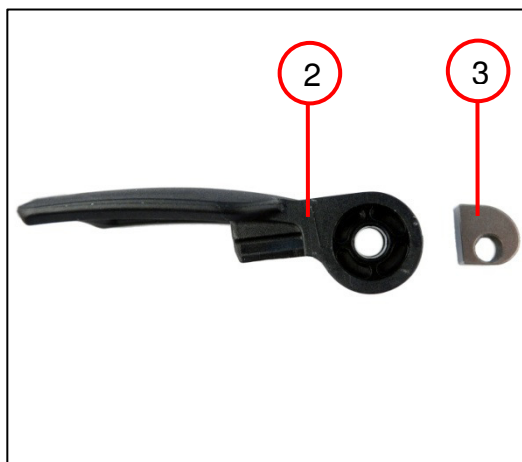
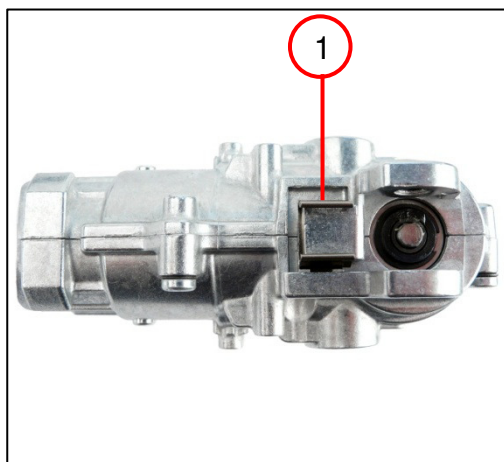

1. Fit the locking spring (1).
2. Position the lever (2).
3. Position the eccentric ring (3) in the correct position.
4. Press in the straight pin (4).

Tools:

- Hammer
- Punch with 5 mm diameter

Fitting

Fitting the gearbox housing

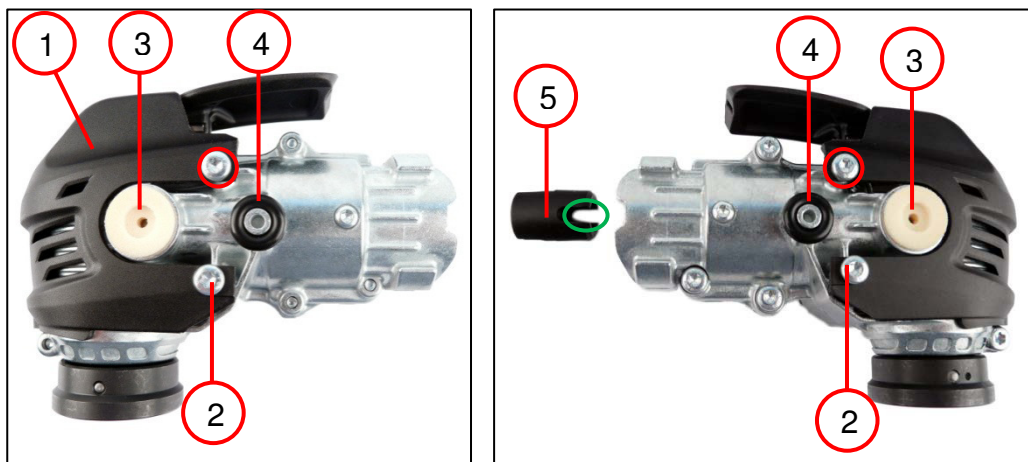

1. Slide the protective cap (1) onto the gearbox housing.
2. Screw in the four screws (2) [$0.8^{+0.2}$ Nm].
3. Insert the two pressure pieces (3).
4. Fit the two rings (4).
5. Slide the clutch part (5) onto the eccentric shaft in the correct position.
 - ☞ The longer guide towards the gearbox housing.

Tools:

- Torque wrench
T15

Fitting

Fitting the motor

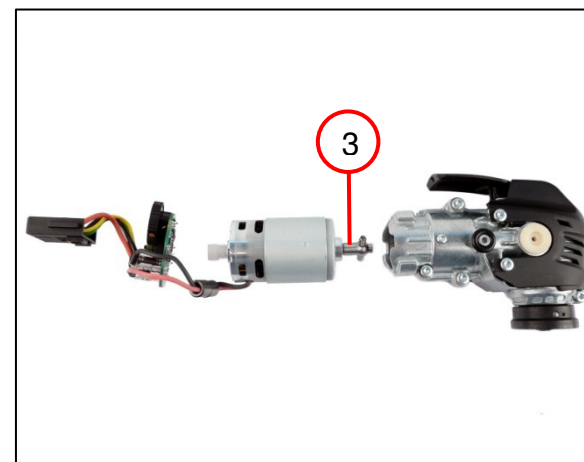
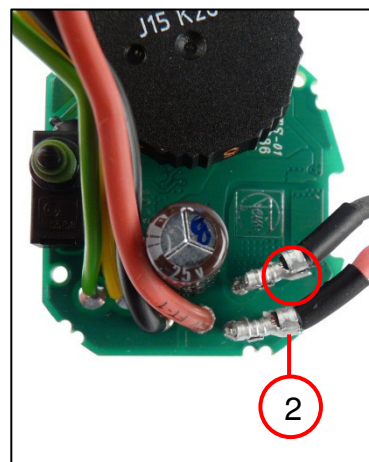
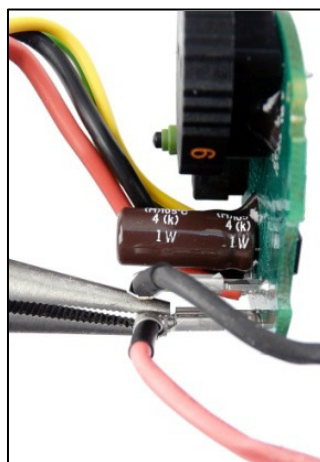
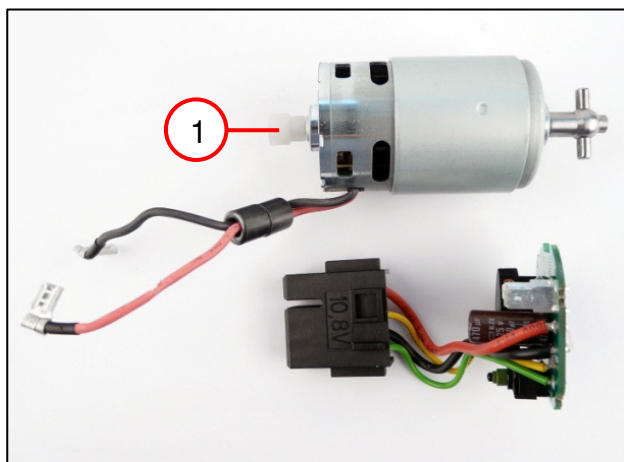

1. Fit the magnet (1).
2. Insert the two cables (2) as shown in the connection diagram.
3. Slide the motor (3) into the clutch part.

Tools:

- Long-nosed pliers

Fitting

Fitting the motor housing

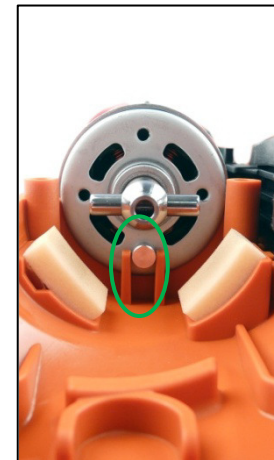
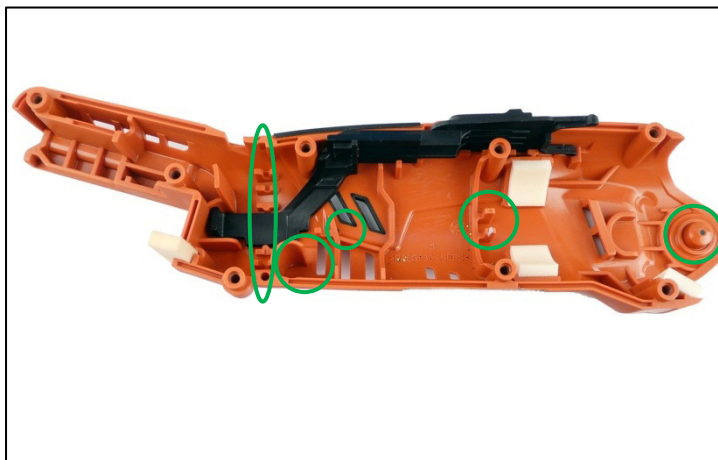
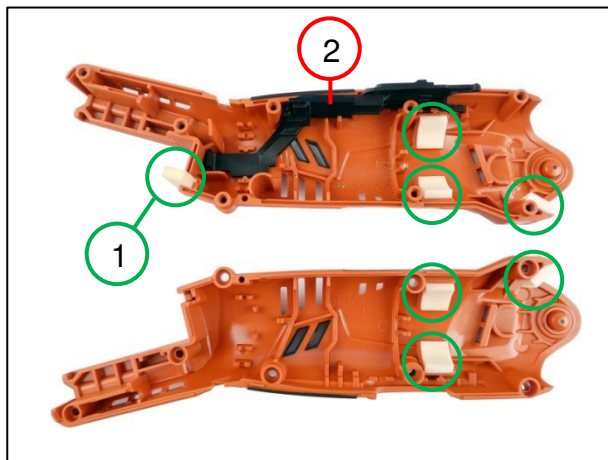

1. Fit the seven pressure pieces (1).
2. Fit the slide switch (2).
3. Insert the electronics, the motor and the tool head into the motor housing.
 - ☞ Observe the guides.
 - ☞ Observe correct cable routing.



Fitting

Fitting the motor housing

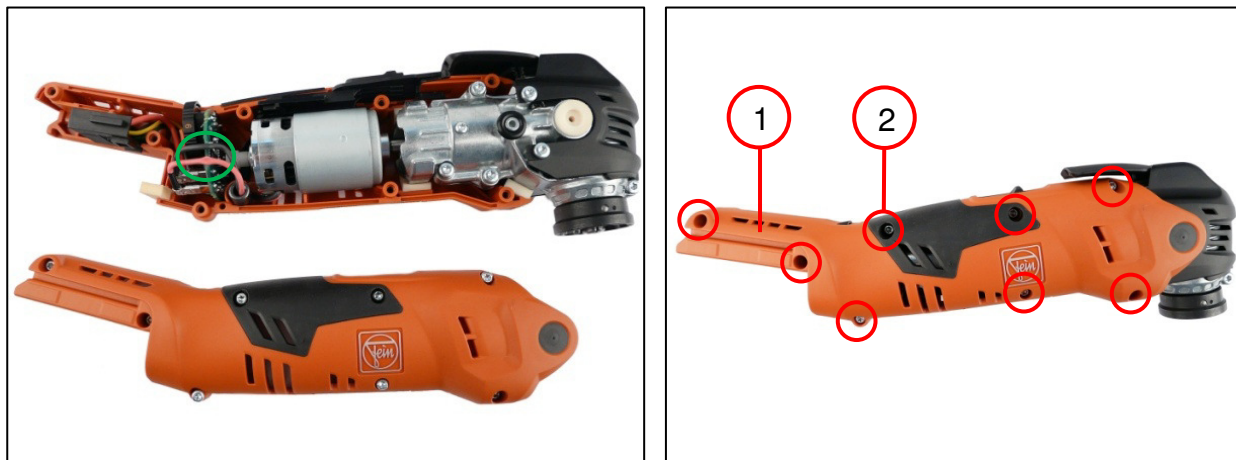

1. Position the motor housing (1).
2. Screw in the eight screws (2) [$1.3^{+0.2}$ Nm].

Tools:

- Torque wrench
T15



Fitting

Fitting the battery



1. Slide on the battery (1).

AFMT 12 Q; AFMT 12 QSL



Connection diagram

Anschlussplan
Connection diagram
Esquema de conexiones
Schéma connexion
Схема соединений
接线图

7 12 91 5 - AFMT12Q	12V
7 12 91 6 - AFMT12	12V
7 12 92 5 - AFMT12QSL	12V
7 12 92 6 - AFMT12SL	12V

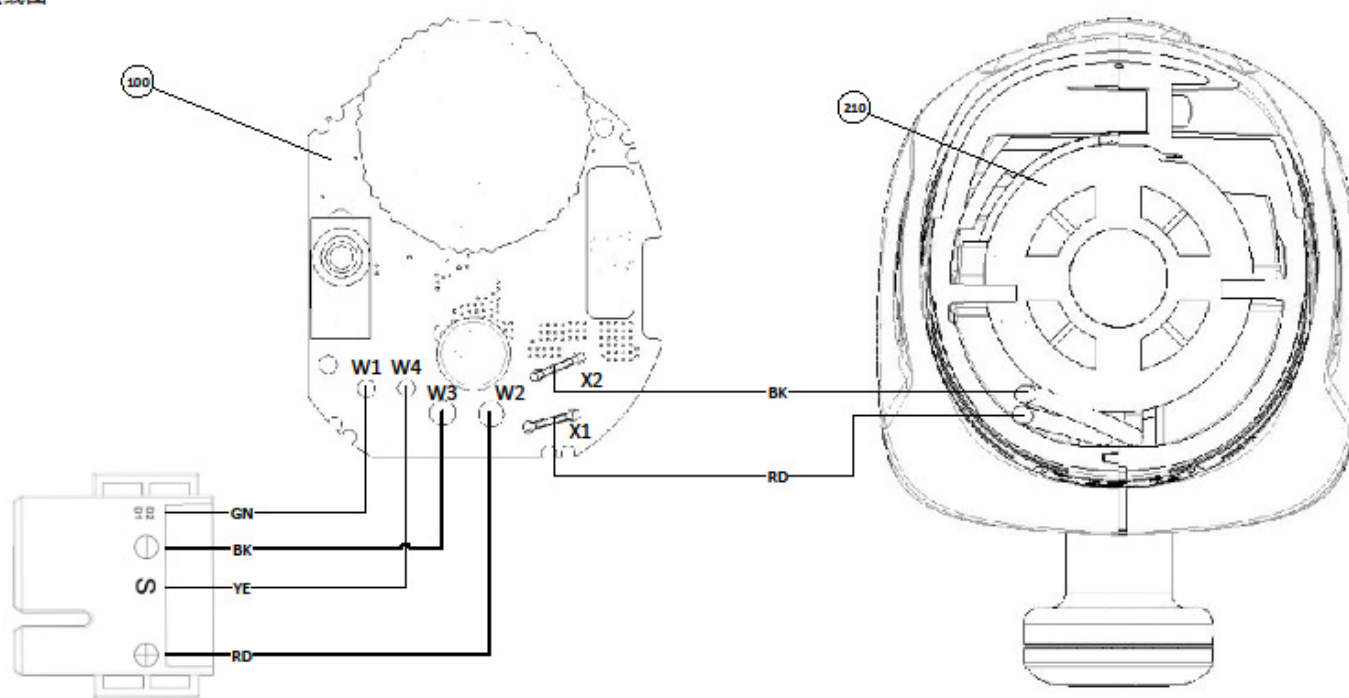

3 41 21 000 103
19.02.2016

